



TECNOLOGIE PER L'INNOVAZIONE - INDUSTRIE 4.0

October 29-31 2020, Fiere di Parma

SAFE FAIR



**COVID-19 PREVENTION AND
CONTAINMENT MEASURES.
FIERE DI PARMA GUIDELINES**

Updated June 2020

Note to the document



The content of this document is drafted in reference to the guidelines defined by AEFI (Association of Italian Trade Fair Organizations), approved by the Conference of the Regions and shared by Fiere di Parma in June 2020, for the expected reopening of trade fairs in Italy starting from July 14, 2020.

In fact, these guidelines do not pose significant limits to the conduct of the fair, but only introduces hygiene, protection, and common sense rules.

Considering, the Covid-19 pandemic situation at June 2020, it is believed that by decreasing the restrictive conditions in Italy, these guidelines could soon be modified, reducing their impact on the set-up, conduct and dismantling of the fair.

Table of contents

1 - GENERAL ORGANISATION / VISITORS

- Regulation of access to the exhibition centre

2 - GENERAL ORGANISATION / THE FAIR

- Sanitizing of areas
- Managing the exhibition centre
- Managing food and drinks
- Managing the conference rooms

3 - GENERAL ORGANISATION / EXHIBITORS

- Exhibition stands



Regulation of access to the exhibition centre

- Distanced lines
- Online tickets with names and identification of a specific day of entry
(admission will be free for operators in the sector)
- One-time "sanitisation" path that will allow:
 - Hand disinfection
 - Measuring of body temperature using a scanner thermometer
 - Misting of a sanitizing solution
- Cameras for numerical detection of accesses
- Entry only allowed if wearing a mask

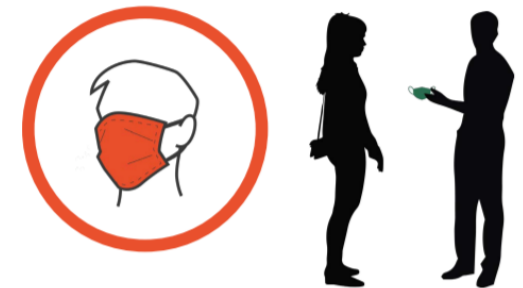
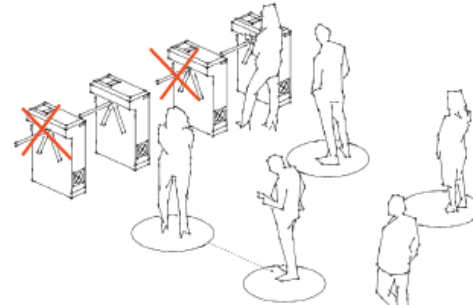

Regulation of access to the exhibition centre

Entrance
North*



* Entrance for
illustration
purposes only

Regulation of access to the exhibition centre

Entrance
West*

* Ingresso a titolo
esemplificativo



Sanitizing of areas

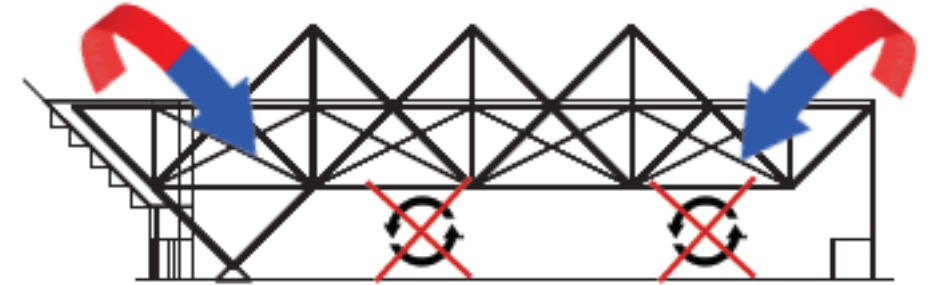

- Elimination of the recirculation of conditioned air and increase in the volume of air coming from outside: ***due to the type of building, fair pavilions have a natural reduction in the risk of diluting pollutants in their large volumes of air***
- Sanitising gel dispensers positioned in common areas
- Cleaning of common areas (toilets, refreshment areas, relaxation areas, entrances) intensified during the exhibition hours
- At the end of the event, deep sanitisation by spraying a disinfectant solution
- Presence of a first aid doctor and ambulance with specifically trained medical staff

POSIZIONATI IN VARI PUNTI
DEL QUARTIERE FIERISTICO



LIZIE DELLE CORSIE E SPAZI COMUNI POTENZIATE
IN UTILIZZO DI APPOSITI SISTEMI DI DETERGENTI
NIFICANTI



Lanes and stand density

- Lanes of a minimum of 4 meters *(in 2019 90% of the lanes were already 4 mt)*
- Lower density of the stands

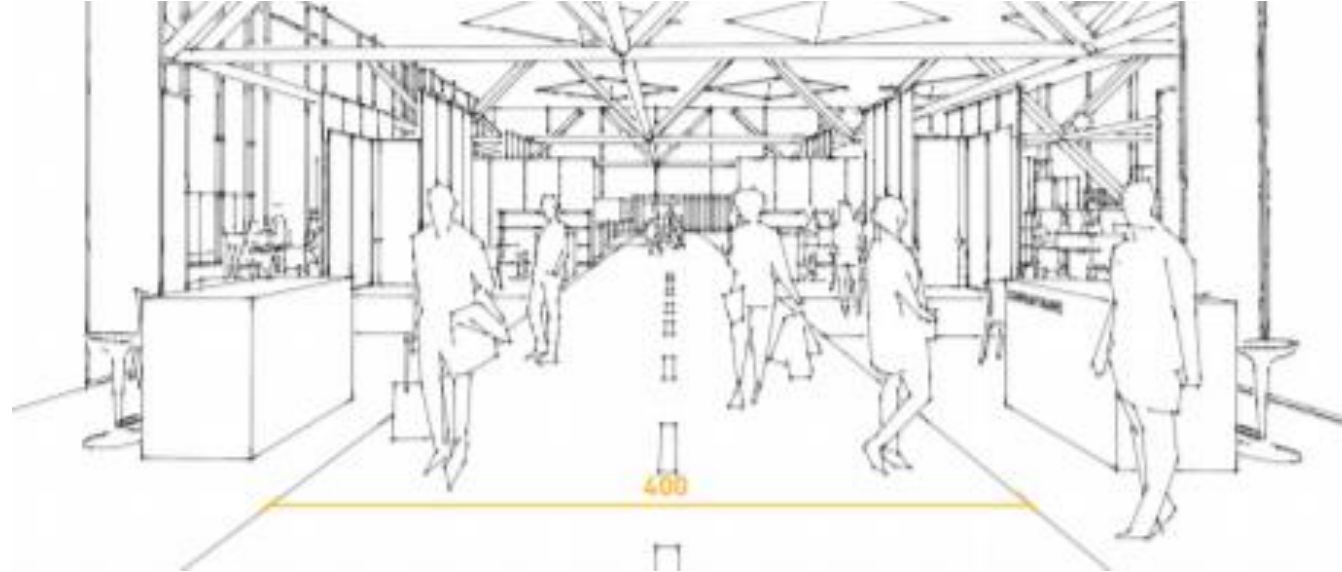

To increase the area available to the movement and consequently increase the distances

Managing the exhibition centre

- Anti crowd control service with dedicated staff
- Positioning of special signs to differentiate the entrances and exits from the pavilions
- Multilingual poster design on the conduct to be adopted

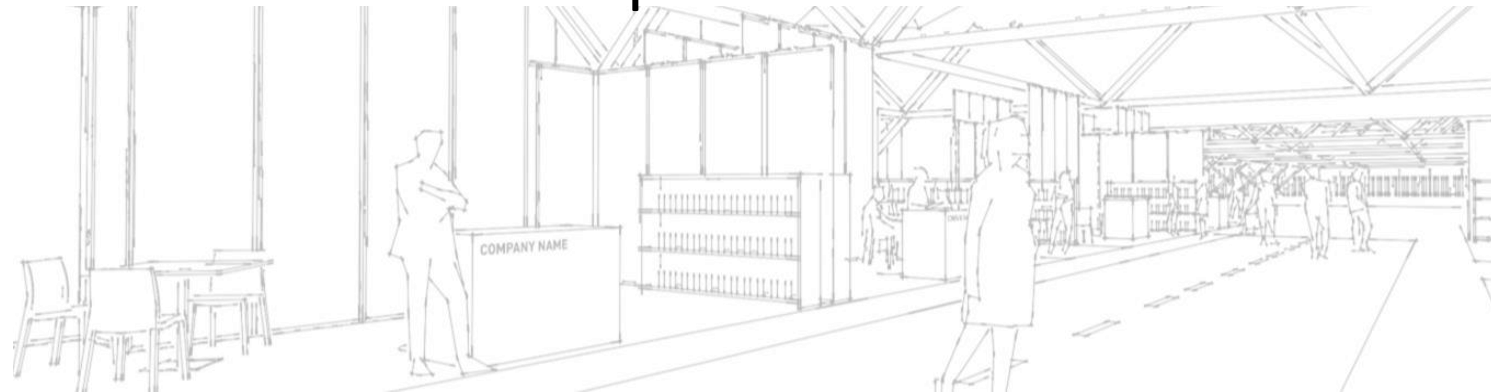
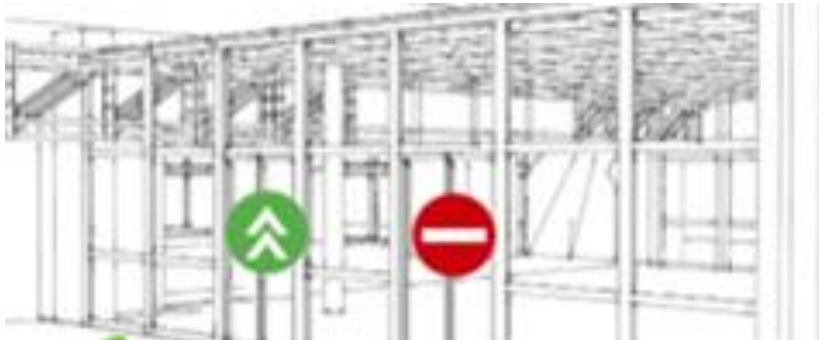

Managing food and drinks



- Disinfection and constant supervision of staff in charge of cleaning the premises
- Sanitisation with suitable products at the end of each event day
- Application of physical barriers to regulate access to refreshment areas and reduce the possibility of contact between users and employees, in addition of course to the presence of all the necessary devices such as masks and gloves
- Increase in contactless payment methods applications and Mobile Proximity
- Increase the distance of the seats in public areas
- Possibility of delivering a lunch box to exhibitors' stands

Managing food and drinks

Refreshment Areas



Exhibition stands

- The stands will have mainly two free sides
- Possibly, an entrance and an exit will have to be identified to avoid crowding

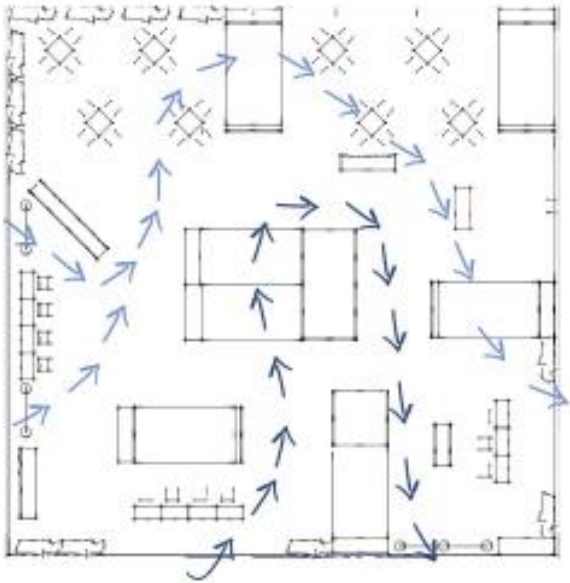
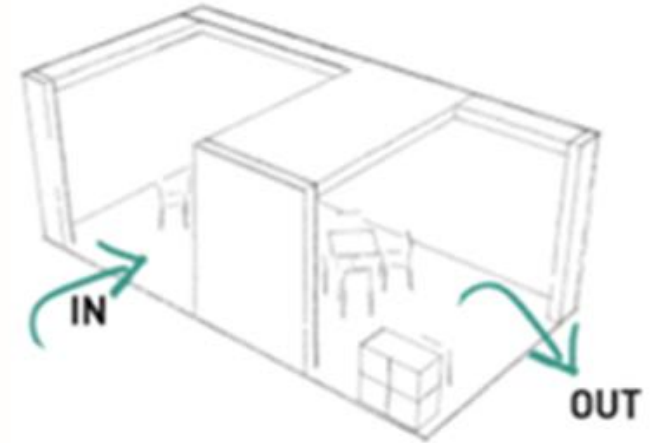

Stands cannot be concealed and must having the minimum number of rooms, to encourage the natural exchange of air inside the stand

Exhibition stands



- It will be the exhibitor's responsibility to make sanitising gel stations available, monitor and assess the number of accesses within his or her space.
(service possibly made available for a fee by Mecspe)
- The informative, promotional and gadget materials can be made available preferably in exhibitors with self-service methods or by using digital systems
- The sale of pre-arranged space is favoured according to set-up criteria compatible with spacing, air exchange, sanitisation of spaces
- Set-up/Disassembly: rules, to be defined shortly, must be followed to protect the health of workers while guaranteeing the correct conduct of the activities.

Recommended indications for all participants

- Wash your hands often and thoroughly with soap and water.
- Use an alcohol-based hand sanitiser if soap and water are not available.
- Avoid touching eyes, nose, and mouth with unwashed hands.
- Avoid near contact with people who are sick or affected.
- Stay home if you are sick or affected.
- Always use disposable tissues. Cover coughing and/or sneezing with a tissue.
- Clean and disinfect frequently touched objects and surfaces.



TECNOLOGIE PER L'INNOVAZIONE - INDUSTRIE 4.0

**October 29-31 2020, Fiere di
Parma**

SAFE FAIR



For more information:

e-mail: info@mecspe.com

Tel.: 02 -332039470

**or contact your fair contact
person directly**